



/AIRFOM – BASICFOM

Cannons that are simple, compact and efficient

Cannons with fire valves that are external to the tank.

The fire valve is equipped with a FOM diaphragm obturator made of elastomer.

The BASICFOM cannons are characterized by the extreme simplicity of their internal structure which makes routine maintenance quick and easy.

Operable through solenoid command valve installed on board the machine.



Technical Specifications

DN50

$P_{max} = 10\text{bar}$

Areas of application:

ZF (-10°C, +60°C) → cold zones, up to room temperature

ZC (-10°C, +100°C) → hot zone (ZC area limitations requires a feasibility assessment by our Technicians)

The BASICFOM cannons, characterized by discharge at 90 ° relative to the tank, are available in the following versions:

◆ **BASICFOM 90**

Standard model can be activated through solenoid connection valve on board the machine

◆ **BASICFOM 90 KY**

Model that incorporates the KYOTO partializing device. KYOTO, when paired with a cannon of the /AIRFOM family, allows not only to contain energy consumption, but also to adjust the effective output of the cannon's discharge (from 0 to 8 bar with $P_{max}=10\text{ bar}$)



/BASICFOM 90 AIRCANNON

| item | DN | Tank lt. | PS bar | TS Min / Max °C | X mm | Y mm | ZF | ZC | HT |
|--------|----|----------|--------|-----------------|------|------|----|----|----|
| 232400 | 50 | 15 | 10 | -10 +60 | 637 | 250 | ● | | |
| 232402 | 50 | 30 | 10 | -10 +60 | 917 | 250 | ● | | |
| 232410 | 50 | 15 | 10 | -10 +100 | 637 | 250 | | ● | |
| 232412 | 50 | 30 | 10 | -10 +100 | 917 | 250 | | ● | |



Energy saving and power management

/BASICFOM KY 90

| item | DN | Tank lt. | PS bar | TS Min / Max °C | X mm | Y mm | ZF | ZC | HT |
|--------|----|----------|--------|-----------------|------|------|----|----|----|
| 232420 | 50 | 15 | 10 | -10 +60 | 637 | 250 | ● | | |
| 232422 | 50 | 30 | 10 | -10 +60 | 917 | 250 | ● | | |
| 232430 | 50 | 15 | 10 | -10 +100 | 637 | 250 | | ● | |
| 232432 | 50 | 30 | 10 | -10 +100 | 917 | 250 | | ● | |

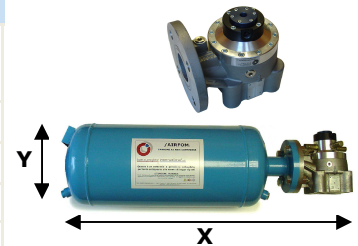

TANKS FOR AIRCANNONS WITH EXTERNAL VALVE (VE)

| item | Description | DN | Capacity lt. | Diameter Øe mm | Height h mm |
|--------|--------------------------------|-----|--------------|----------------|-------------|
| 610002 | AIRCANNON TANK VE DN50 5 LT | 50 | 5 | 250 | 230 |
| 610004 | AIRCANNON TANK VE DN50 15 LT | 50 | 15 | 250 | 450 |
| 610006 | AIRCANNON TANK VE DN50 30 LT | 50 | 30 | 250 | 730 |
| 610012 | AIRCANNON TANK VE DN100 50 LT | 100 | 50 | 350 | 770 |
| 610016 | AIRCANNON TANK VE DN100 75 LT | 100 | 75 | 400 | 770 |
| 610021 | AIRCANNON TANK VE DN100 100 LT | 100 | 100 | 400 | 970 |
| 610026 | AIRCANNON TANK VE DN100 150 LT | 100 | 150 | 500 | 985 |
| 610035 | AIRCANNON TANK VE DN150 100 LT | 150 | 100 | 400 | 970 |
| 610038 | AIRCANNON TANK VE DN150 150 LT | 150 | 150 | 500 | 985 |

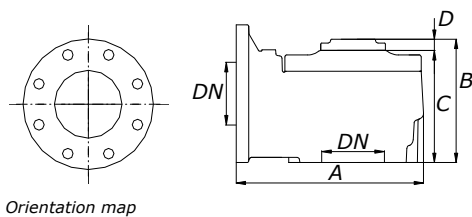
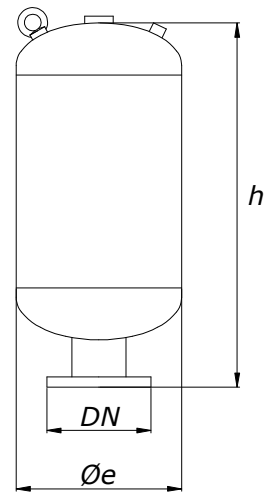

| Fire valve /BASICFOM 90 | | | | | |
|-------------------------|------|------|------|------|------|
| DN mm | A mm | B mm | C mm | D mm | E mm |
| 50 | 187 | 146 | 131 | 15 | - |

| Fire valve /BASICFOM KY 90 | | | | | |
|----------------------------|------|------|------|------|------|
| DN mm | A mm | B mm | C mm | D mm | E mm |
| 50 | 187 | 209 | 179 | 30 | - |