



## **/AIRFOM - CRONOFOM**

*Cannons that are rugged, compact, efficient and highly reliable*

Cannons with fire valves that are external to the tank.

The fire valve is equipped with a FOM diaphragm obturator made of elastomer.

Unique to the CRONOFOM and KYOTOFOM cannons is the fact of being equipped with a floating diaphragm obturator (FOM) which is extremely lightweight and inserted into a valve body that is robust and very compact. The adoption of FOM obturators has allowed an extreme simplification of the internal structure of these cannons thus significantly reducing the number of components: this makes maintenance quick and easy, with reduced costs.

The CRONOFOM cannons incorporate the CRONO start device for remote (max 9 metres) operation of the cannon without suffering load losses.



The CRONOFOM cannons are divided into two main models as a function of the shape of the valve's body:

◆ **CRONOFOM 90**

Model in which the discharge of the cannon is placed at a 90° with respect to coupling with the tank

◆ **CRONOFOM 00**

Model in which the discharge of the cannon is in axis with the tank

### *Technical Specifications*

DN50

$P_{max} = 10bar$

Areas of application:

**ZF** (-10°C, +60°C) → cold zones, up to room temperature

**ZC** (-10°C, +100°C) → hot zone (ZC area limitations requires a feasibility assessment by our Technicians)

**N.B.** For remote operation further than 9 metres use the /LOGOS multi-function valve.



**/CRONOFOM 90 AICANNON**

item	DN	Tank lt.	PS bar	TS Min / Max °C	X mm	Y mm	ZF	ZC	HT
232500	50	15	10	-10 +60	637	250	●		
232502	50	30	10	-10 +60	917	250	●		
232510	50	15	10	-10 +100	637	250		●	
232512	50	30	10	-10 +100	917	250		●	
232520	100	50	10	-10 +60	1070	350	●		
232522	100	75	10	-10 +60	1070	400	●		
232524	100	100	10	-10 +60	1270	400	●		
232526	100	150	10	-10 +60	1285	500	●		
232530	100	50	10	-10 +100	1070	350		●	
232532	100	75	10	-10 +100	1070	400		●	
232534	100	100	10	-10 +100	1270	400		●	
232536	100	150	10	-10 +100	1285	500		●	



**/CRONOFOM 00 AICANNON**

item	DN	Tank lt.	PS bar	TS Min / Max °C	X mm	Y mm	ZF	ZC	HT
235600	100	50	10	-10 +60	1010	350	●		
235602	100	75	10	-10 +60	1010	400	●		
235604	100	100	10	-10 +100	1210	400	●		
235606	100	150	10	-10 +100	1225	500	●		
235610	100	50	10	-10 +100	1010	350		●	
235612	100	75	10	-10 +100	1010	400		●	
235614	100	100	10	-10 +100	1210	400		●	
235616	100	150	10	-10 +100	1225	500		●	

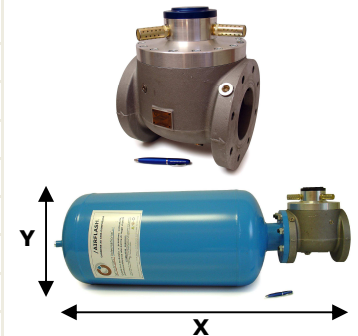

**TANKS FOR AIRCANNONS WITH EXTERNAL VALVE (VE)**

item	Description	DN	Capacity lt.	Diameter Øe mm	Height h mm
610002	AIRCANNON TANK VE DN50 5 LT	50	5	250	230
610004	AIRCANNON TANK VE DN50 15 LT	50	15	250	450
610006	AIRCANNON TANK VE DN50 30 LT	50	30	250	730
610012	AIRCANNON TANK VE DN100 50 LT	100	50	350	770
610016	AIRCANNON TANK VE DN100 75 LT	100	75	400	770
610021	AIRCANNON TANK VE DN100 100 LT	100	100	400	970
610026	AIRCANNON TANK VE DN100 150 LT	100	150	500	985
610035	AIRCANNON TANK VE DN150 100 LT	150	100	400	970
610038	AIRCANNON TANK VE DN150 150 LT	150	150	500	985

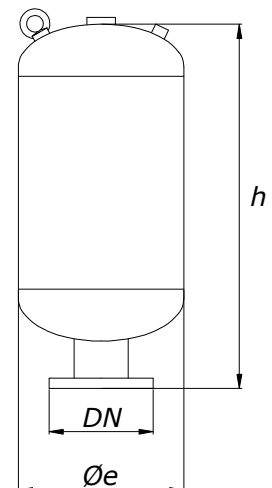

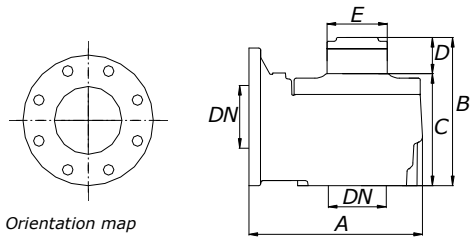

Fire valve /CRONOFOM 90					
DN mm	A mm	B mm	C mm	D mm	E mm
50	187	178	131	47	74
100	300	237	179	58	104

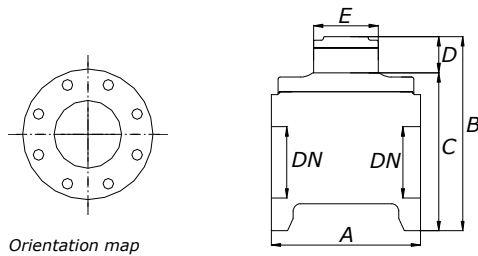

Fire valve /CRONOFOM 00					
DN mm	A mm	B mm	C mm	D mm	E mm
100	240	313	255	58	104

TANKS FOR AIRCANNONS WITH EXTERNAL VALVE (VE)			
Volume Lt.	DN	Øe mm	h mm
15	50	250	450
30	50	250	730
50	100	350	770
75	100	400	770
100	100	400	970
100	150	400	970
150	100	500	985
150	150	500	985

