



/AIRFLASH - KYOTOTECH

Cannons that are compact, efficient, highly reliable with integrated energy saving device

Cannons with fire valves that are external to the tank.

The fire valve is equipped with a metal alloy obturator suitable for severe operating conditions.

The KYOTOTECH cannons incorporate both the CRONO start device for remote (max 9 metres) operation of the cannon without suffering load losses and the KYOTO device. KYOTO allows to control the power discharge from the cannon allowing for the containment of energy consumption thus preventing unnecessary waste.

The modularity that characterizes these cannons greatly facilitates maintenance tasks because, upon unbolting the inlet section of fire valve, you can pull out the obturator assembly together as one unit without having to uncouple the tank in use.



The KYOTOTECH cannons are divided into two main models as a function of the shape of the valve's body:

◆ **KYOTOTECH 90**

Model in which the discharge of the cannon is placed at a 90° with respect to coupling with the tank

◆ **KYOTOTECH 00**

Model in which the discharge of the cannon is in axis with the tank

Technical Specifications

DN50 / DN100

P_{max} = 10bar

Areas of application:

ZF (-10°C, +60°C) → cold zones, up to room temperature

ZC (-10°C, +100°C) → hot zones

HT (-10°C, +100°C) → high temperature zone Tmax=100°C zone and subject to direct heat radiation and/or pronounced corrosion

N.B. For remote operation further than 9 metres use the LOGOS multi-function valve.



Energy saving

/KYOTOTECH 90 AIRCANNON

item	DN	Tank lt.	PS bar	TS Min / Max °C	X mm	Y mm	ZF	ZC	HT
230900	50	15	10	-10 +60	637	250	●		
230902	50	30	10	-10 +60	917	250	●		
230910	50	15	10	-10 +100	637	250		●	
230912	50	30	10	-10 +100	917	250		●	
230920	50	15	10	-10 +100	637	250			●
230922	50	30	10	-10 +100	917	250			●
231000	100	50	10	-10 +60	1070	350	●		
231002	100	75	10	-10 +60	1070	400	●		
231004	100	100	10	-10 +60	1270	400	●		
231006	100	150	10	-10 +60	1285	500	●		
231020	100	50	10	-10 +100	1070	350		●	
231022	100	75	10	-10 +100	1070	400		●	
231024	100	100	10	-10 +100	1270	400		●	
231026	100	150	10	-10 +100	1285	500		●	
231040	100	50	10	-10 +100	1070	350			●
231042	100	75	10	-10 +100	1070	400			●
231044	100	100	10	-10 +100	1270	400			●
231046	100	150	10	-10 +100	1285	500			●



Energy saving

/KYOTOTECH 00 AIRCANNON

item	DN	Tank lt.	PS bar	TS Min / Max °C	X mm	Y mm	ZF	ZC	HT
235350	100	50	10	-10 +60	350	502	●		
235352	100	75	10	-10 +60	400	527	●		
235354	100	100	10	-10 +60	400	527	●		
235356	100	150	10	-10 +60	500	577	●		
235380	100	50	10	-10 +100	350	502		●	
235382	100	75	10	-10 +100	400	527		●	
235384	100	100	10	-10 +100	400	527		●	
235386	100	150	10	-10 +100	500	577		●	
235410	100	50	10	-10 +100	350	502			●
235412	100	75	10	-10 +100	400	527			●
235414	100	100	10	-10 +100	400	527			●
235416	100	150	10	-10 +100	500	577			●





TANKS VOR AIRCANNONS WITH EXTERNAL VALVE (VE)

item	Description	DN	Capacity lt.	Diameter \varnothing_e mm	Height h mm
610002	AIRCANNON TANK VE DN50 5 LT	50	5	250	230
610004	AIRCANNON TANK VE DN50 15 LT	50	15	250	450
610006	AIRCANNON TANK VE DN50 30 LT	50	30	250	730
610012	AIRCANNON TANK VE DN100 50 LT	100	50	350	770
610016	AIRCANNON TANK VE DN100 75 LT	100	75	400	770
610021	AIRCANNON TANK VE DN100 100 LT	100	100	400	970
610026	AIRCANNON TANK VE DN100 150 LT	100	150	500	985
610035	AIRCANNON TANK VE DN150 100 LT	150	100	400	970
610038	AIRCANNON TANK VE DN150 150 LT	150	150	500	985

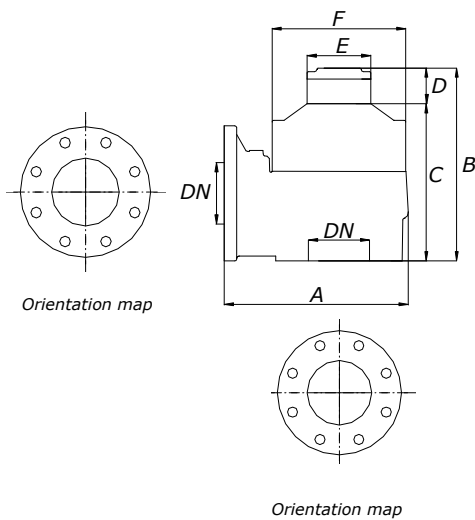
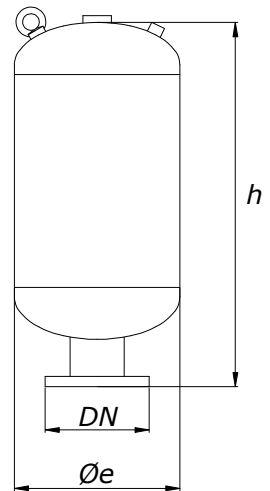

Fire valve /KYOTOTECH 90						
DN mm	A mm	B mm	C mm	D mm	E mm	F mm
50	187	255	185	70	104	130
100	300	326	256	70	104	218

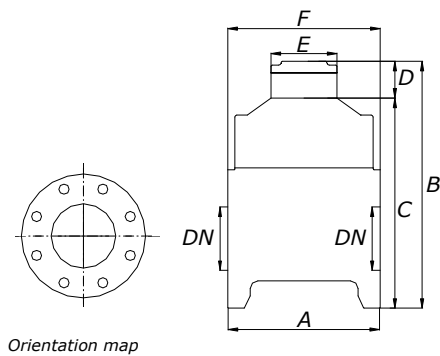

Fire valve /KYOTOTECH 00						
DN mm	A mm	B mm	C mm	D mm	E mm	F mm
100	240	402	332	70	104	218