



/AIRFOM - LIGHT

Light cannons, simple and efficient, ideal for the disintegration of small blockages (pipes, chutes, ducts, small dust deposits)

Cannons with fire valves that are part of the tank.
The fire valve is equipped with an elastomer cup-shaped obturator.

Technical Specifications

DN50

$P_{max} = 10\text{bar}$

Areas of application:

ZF (-10°C, +60°C) → cold zones, up to room temperature

ZC (-10°C, +100°C) → hot zone (ZC area limitations requires a feasibility assessment by our Technicians)



The LIGHT cannon is available in the following versions:

◆ **LIGHT BASE**

Model activated using a solenoid connection valve on board the machine or can be equipped with a CRONO trigger independently wired onto the machine for remote (max 9 metres) operation of the cannon without suffering load losses

◆ **LIGHT KY**

Model that incorporates the KYOTO partializing device. KYOTO, when paired with a cannon of the /AIRFOM family, allows not only to contain energy consumption, but also to adjust the effective output of the cannon's discharge (from 0 to 8 bar with $P_{max}=10\text{ bar}$)

◆ **LIGHT CR**

Model that incorporates the CRONO start device for remote (max 9 metres) operation of the cannon without suffering load losses

◆ **LIGHT CRKY**

Model that incorporates both the CRONO start device for remote control and the KYOTO partializing device. KYOTO, when paired with a cannon of the /AIRFOM family, allows not only to contain energy consumption, but also to adjust the effective output of the cannon's discharge (from 0 to 8 bar with $P_{max}=10\text{ bar}$)

N.B. For remote operation further than 9 metres use the /LOGOS multi-function valve.



/LIGHT BASE AIRCANNON

item	DN	Tank ft.	PS bar	TS Min / Max °C	X mm	Y mm	ZF	ZC	HT
232460	50	5	10	-10 +60	250	271	●		
232462	50	15	10	-10 +60	250	486	●		
232464	50	30	10	-10 +60	250	776	●		
232470	50	5	10	-10 +100	250	271		●	
232472	50	15	10	-10 +100	250	486		●	
232474	50	30	10	-10 +100	250	776		●	



/LIGHT CR AIRCANNON

item	DN	Tank ft.	PS bar	TS Min / Max °C	X mm	Y mm	ZF	ZC	HT
232440	50	5	10	-10 +60	250	287	●		
232442	50	15	10	-10 +60	250	502	●		
232444	50	30	10	-10 +60	250	792	●		
232450	50	5	10	-10 +100	250	287		●	
232452	50	15	10	-10 +100	250	502		●	
232454	50	30	10	-10 +100	250	792		●	

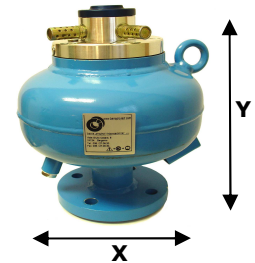

Energy saving and power management

/LIGHT KY AIRCANNON

item	DN	Tank ft.	PS bar	TS Min / Max °C	X mm	Y mm	ZF	ZC	HT
230260	50	5	10	-10 +60	250	286	●		
230262	50	15	10	-10 +60	250	501	●		
230264	50	30	10	-10 +60	250	791	●		
230270	50	5	10	-10 +100	250	286		●	
230272	50	15	10	-10 +100	250	501		●	
230274	50	30	10	-10 +100	250	791		●	

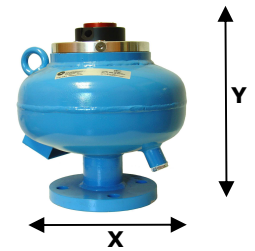

Energy saving and power management

/LIGHT CRKY AIRCANNON

item	DN	Tank ft.	PS bar	TS Min / Max °C	X mm	Y mm	ZF	ZC	HT
230240	50	5	10	-10 +60	250	318	●		
230242	50	15	10	-10 +60	250	533	●		
230244	50	30	10	-10 +60	250	823	●		
230250	50	5	10	-10 +100	250	318		●	
230252	50	15	10	-10 +100	250	533		●	
230254	50	30	10	-10 +100	250	823		●	

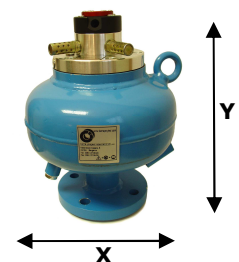



TANKS FOR /LIGHT AIRCANNONS

item	Description	DN	Capacity Lt.	Diameter Øe mm	Height h mm
610061	LIGHT TANK DN32 5 LT	32	5	250	235
610064	LIGHT TANK DN32 10 LT	32	10	250	395
610067	LIGHT TANK DN50 5 LT	50	5	250	240
610070	LIGHT TANK DN50 15 LT	50	15	250	455
610073	LIGHT TANK DN50 30 LT	50	30	250	745

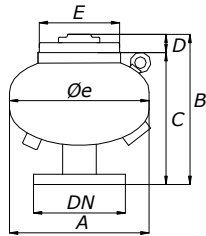
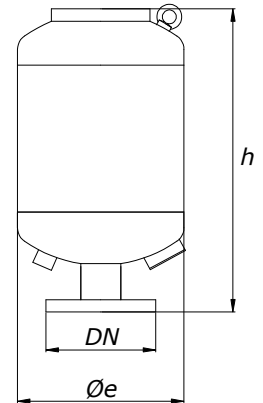

/LIGHT BASE								/LIGHT KY	
Volume Lt.	DN	Øe mm	A mm	B mm	C mm	D mm	E mm	B* mm	D* mm
5	50	250	250	271	240	31	144	286	46
15	50	250	250	486	455	31	144	501	46
30	50	250	250	776	745	31	144	791	46

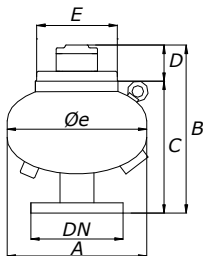

/LIGHT CR								/LIGHT CRKY	
Volume Lt.	DN	Øe mm	A mm	B mm	C mm	D mm	E mm	B* mm	D* mm
5	50	250	250	303	240	63	144	318	78
15	50	250	250	518	455	63	144	533	78
30	50	250	250	808	745	63	144	823	78

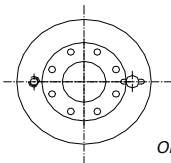

Orientation map

(*) The dimension is different if the KYOTO device, for energy saving and/or power management, is installed.